

Installation (cont)...

- 2.5. Mount the base in the desired position using the fasteners supplied.
- 2.6. Replace the fan body in-between the spigots and tighten the two retaining clamps.

Fan Maintenance

- 3.1. Inspect the fan at least once every 12 months to ensure that the motor and fan blades are clean. Any build up of dust should be removed using a non-abrasive cleaner.
- 3.2. All fastenings should be checked for tightness.
- 3.3. Bearings are of the 'sealed for life' type and will not need a detailed inspection.

Wiring Diagram

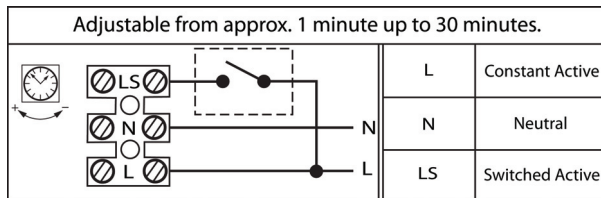

Please note that the ProVent with run-on timer (models RIL-150T and RIL-200T) is single speed only, is not suitable for speed control and does not come with a plug and lead.



In-Line Duct Mounted Fan

RIL-150T
RIL-200T

INSTALLATION & MAINTENANCE INSTRUCTIONS

	Fantech Contacts	
	Head Office Victoria - Melbourne A.B.N. 11 005 434 024 Ph: +61 (3) 9554 7845 Fax: +61 (3) 9554 7833 Email: info@fantech.com.au	New Zealand Auckland H.O. (09) 444 6266 Christchurch (03) 379 8622 Wellington (04) 566 0532
Australia Adelaide (08) 8294 0530 Brisbane (07) 3299 9888 Darwin (08) 8947 0447 Melbourne H.O. (03) 9554 7845 Perth (08) 9209 4999 Sydney (02) 8811 0400	Asia For agents in the Asian region call (603) 7846 0340 or visit www.elfantechasia.com	
www.fantech.com.au		

Specification

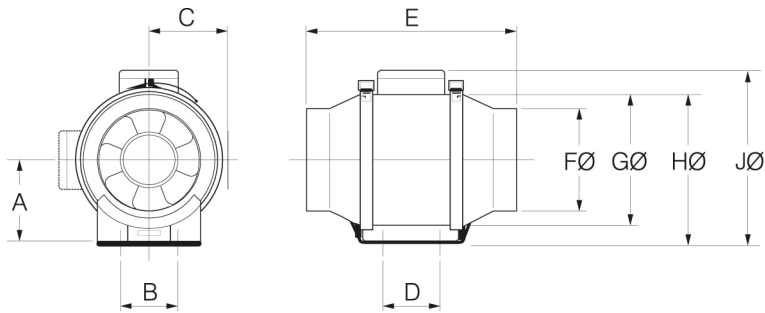

Model	Dimensions									Weight kg
	A	B	C	D	E	F	G	H	J	
RIL-150T	112	60	100	80	295	147	200	225	236	2.7
RIL-200T	124	94	108.5	100	302	198	217	235	265	4.9

Model	Speed r/min	Electrical Data	
		FLC Amps	Input W
RIL-150T	2500	0.22	50
RIL-200T	2500	0.50	120

General

- 1.1. It is important that these Installation and Maintenance Instructions are fully adhered to.
- 1.2. All electrical installations must be carried out by suitably qualified and competent personnel in accordance with all statutory requirements.
- 1.3. The fan is designed for use in an ambient temperature of up to 40°C. It is not suitable for corrosive or explosive atmospheres.
- 1.4. The installer should provide easy access to the fan to facilitate future maintenance, and ensure that the fan is adequately supported.

- 1.5. This product is not intended for use by persons (including children) with reduced physical sensory or mental capabilities, or lack of experience and knowledge, unless they have been given supervision or instruction concerning use of the product by a person responsible for their safety. Children should be supervised to ensure that they do not play with the product.
- 1.6. Precautions must be taken to avoid back-flow of gases into the room from the open flue of gas or other fuel burning appliances.
- 1.7. A minimum of one (1) metre of duct is to be fitted to the fan inlet and discharge spigots.
- 1.8. Fan Run-on is from 1 to 30 minutes. Adjust via the trim-pot fitted in the junction box.

Installation

Warning: The fan must be isolated from the power supply during installation and maintenance.

- 2.1. Upon receipt, the fan should be inspected for any damage.
- 2.2. Check the details on the rating plate to ensure that the correct power supply is available
- 2.3. Means for electrical disconnection must be incorporated in the wiring installation in accordance with the relevant wiring regulations.
- 2.4. Remove the fan body from the spigots that are attached to the base by releasing the two retaining clamps (RIL-150T, see diagram), or the two clamp screws (RIL-200T).

